

Bouwnummer 702 - 155m² GBO

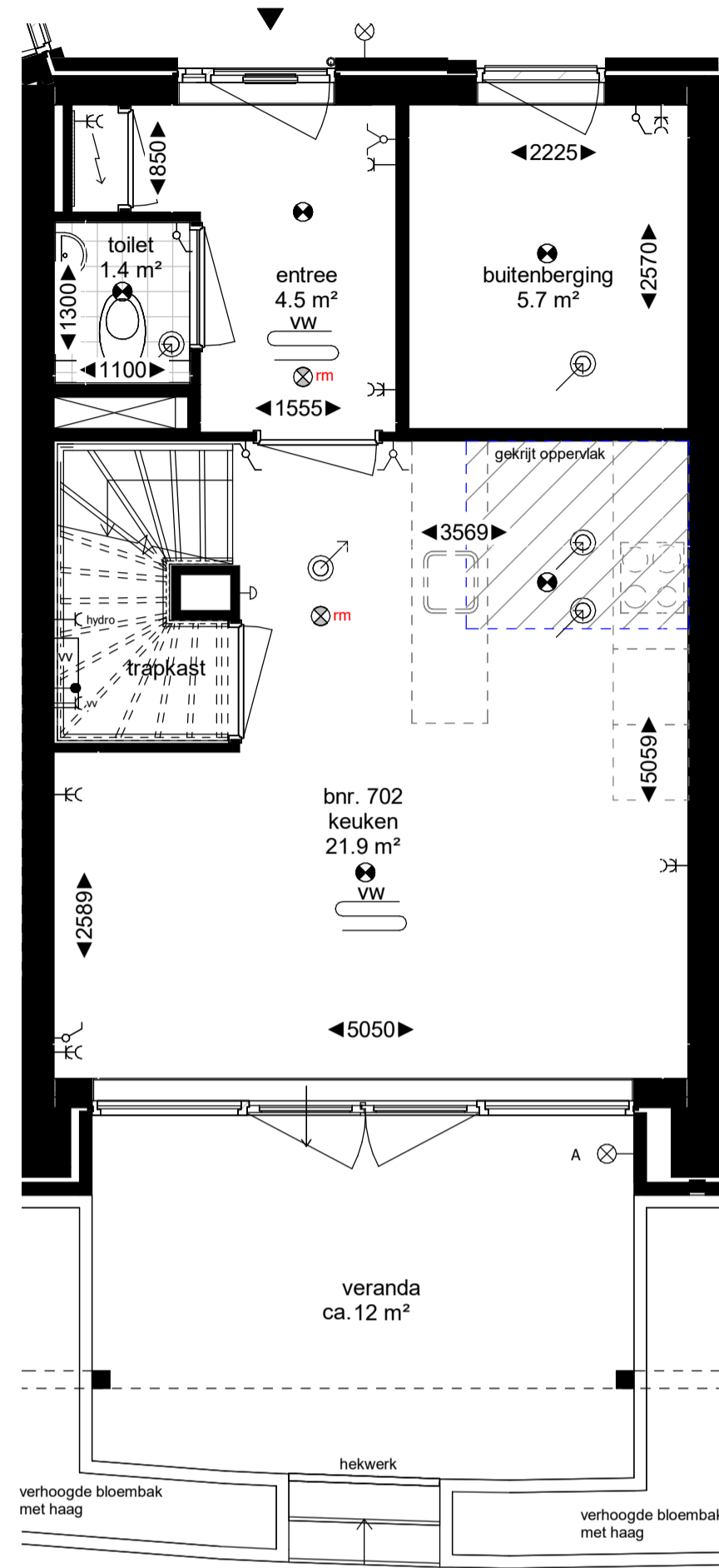

begane grond
schaal 1 : 50

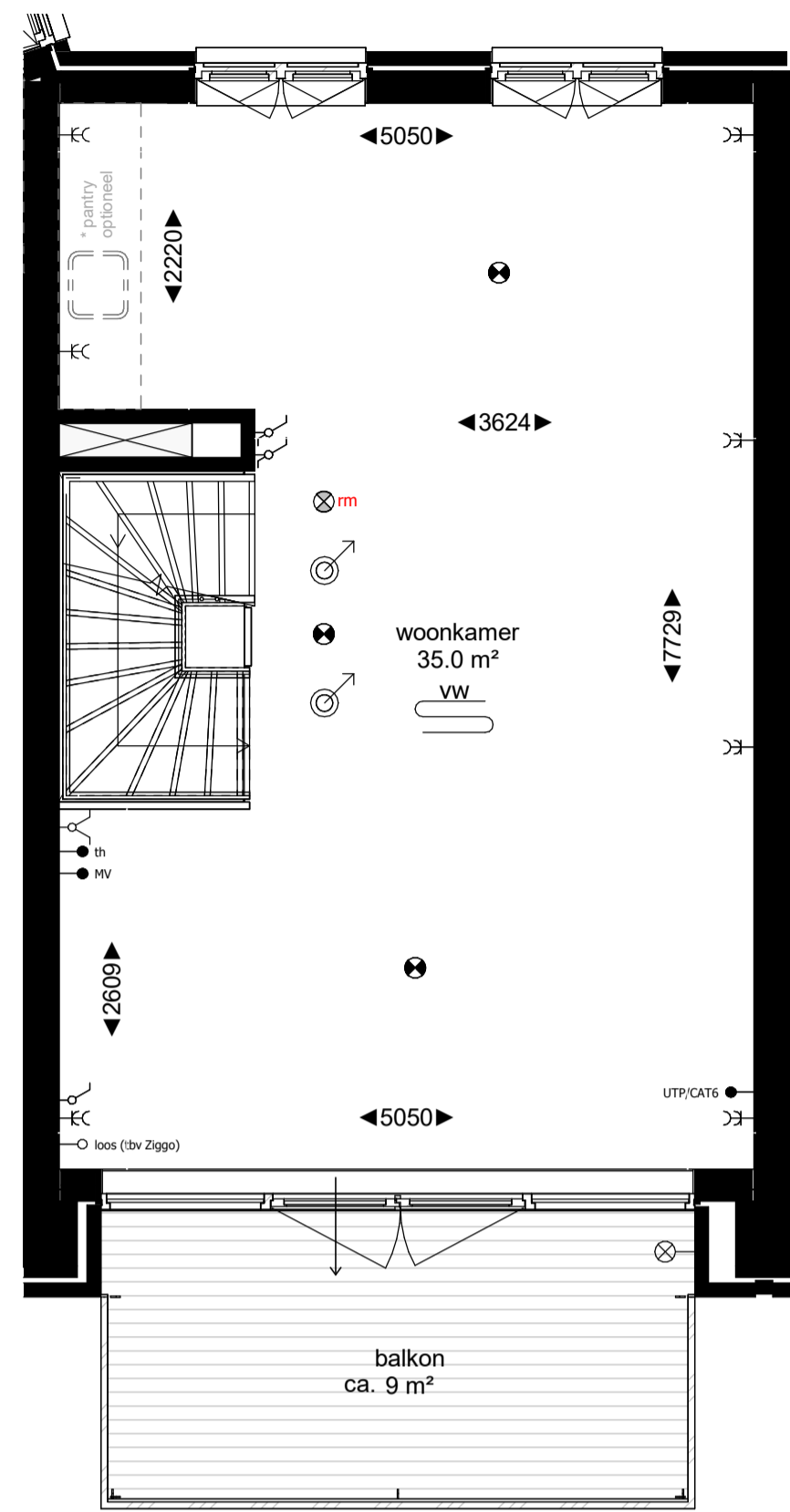

1e verdieping
schaal 1 : 50

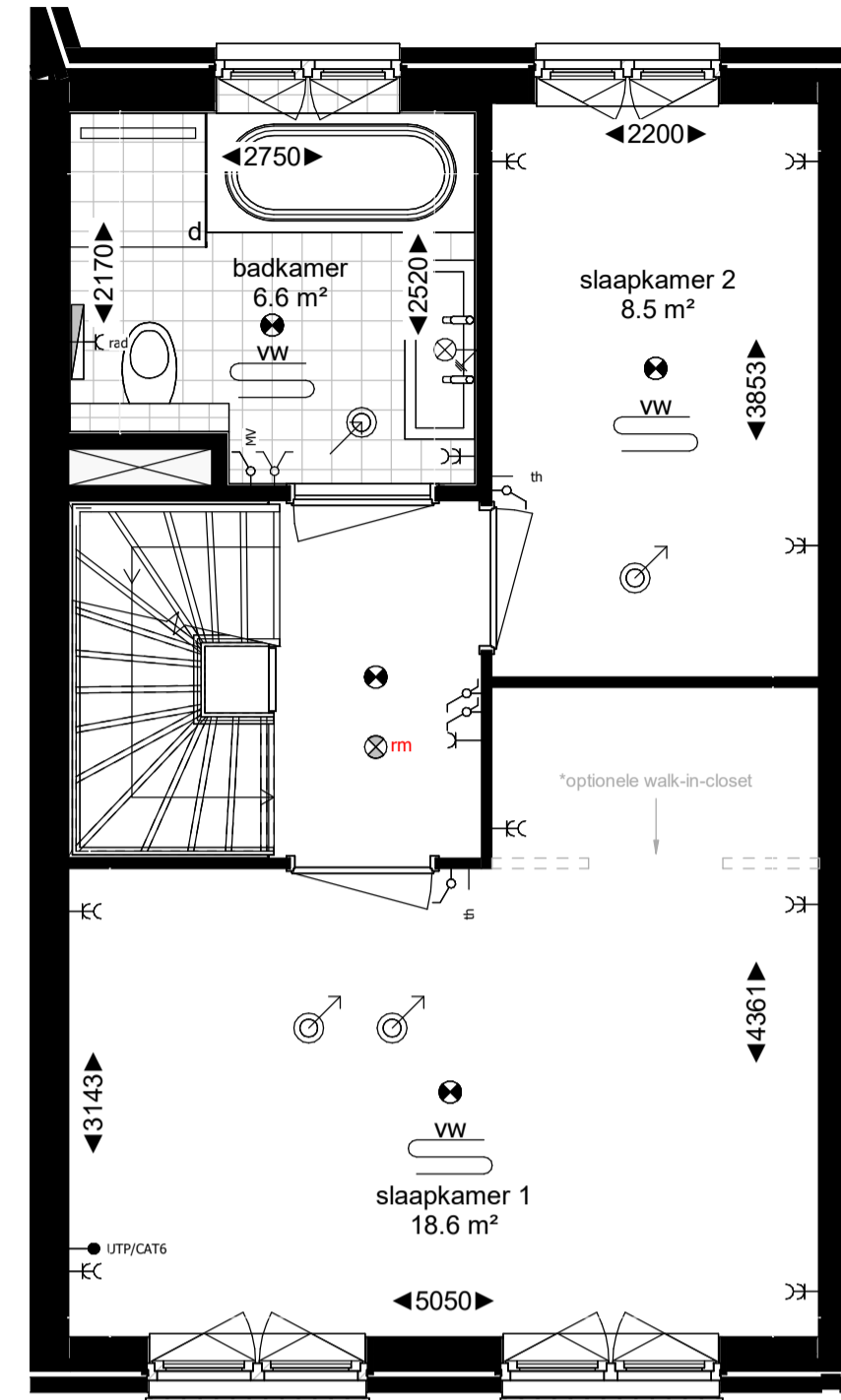

2e verdieping
schaal 1 : 50

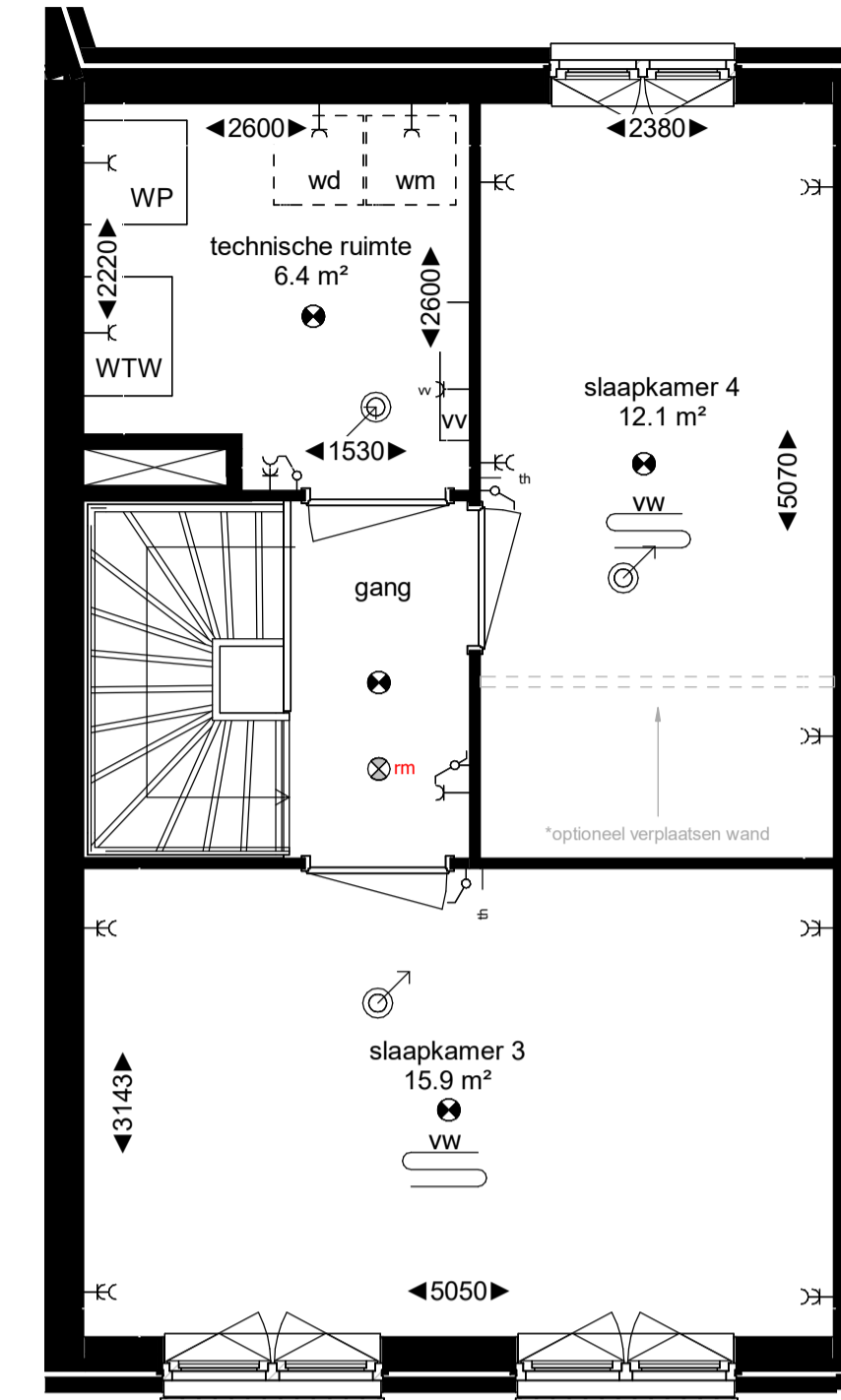

3e verdieping
schaal 1 : 50

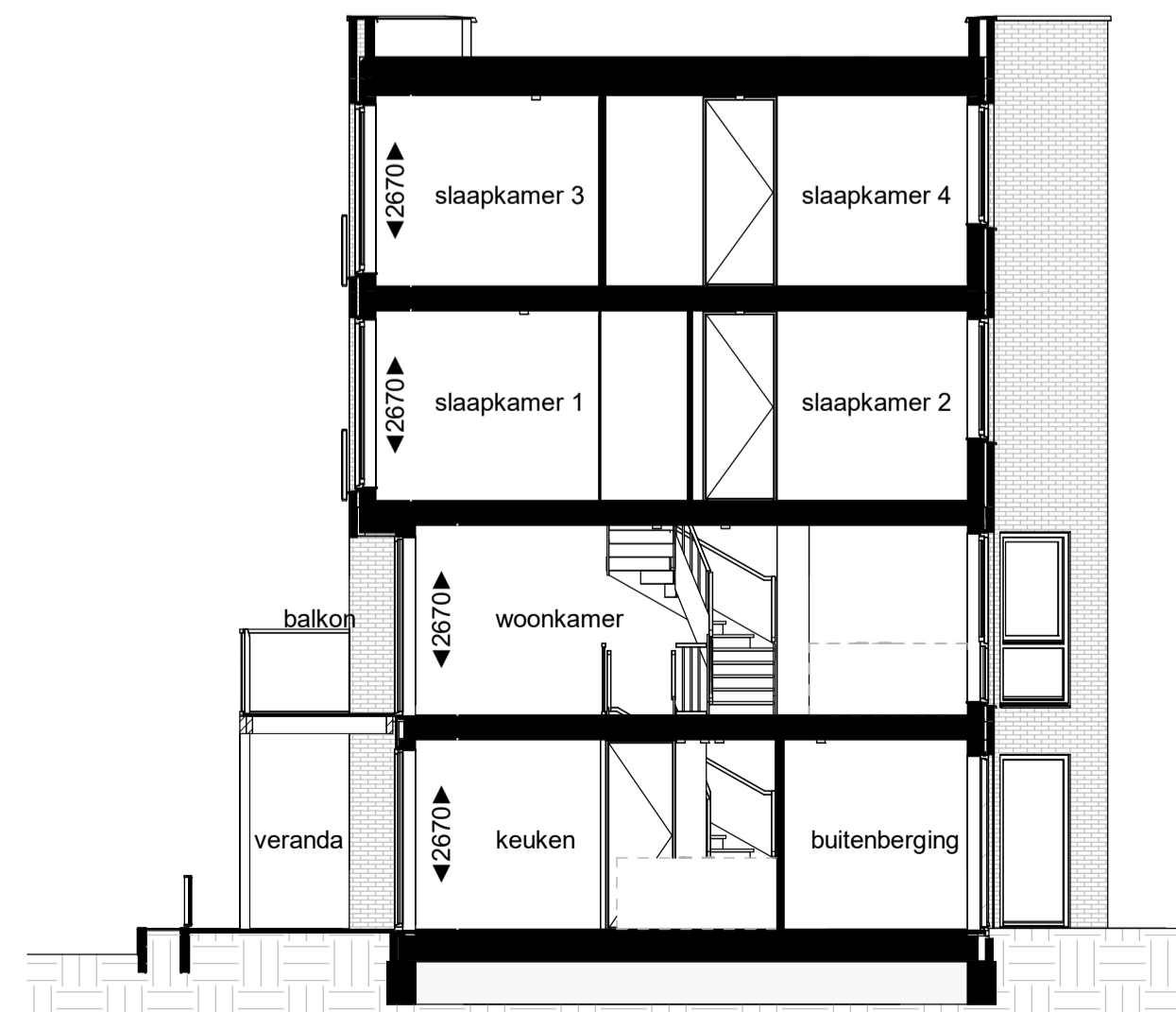

doorsnede
schaal 1 : 100





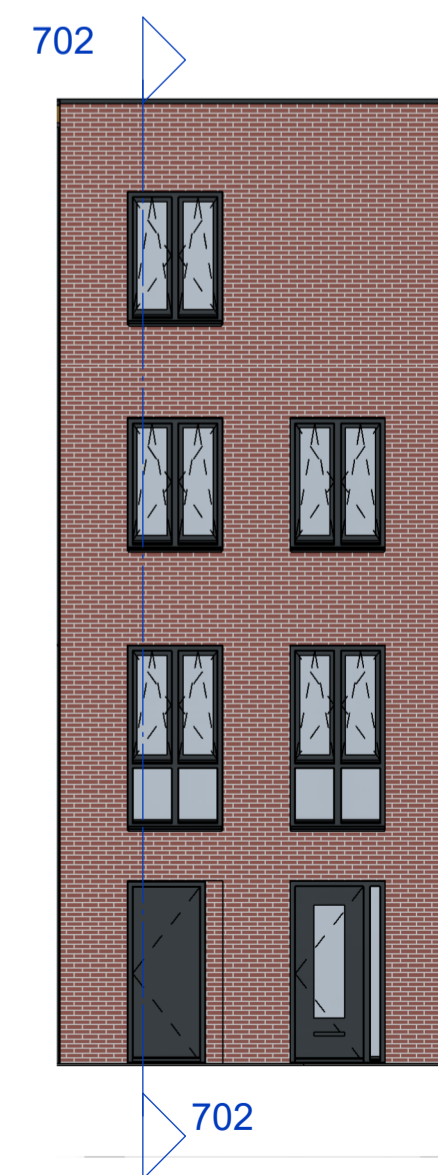









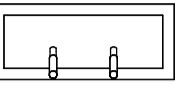

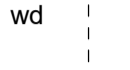
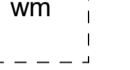

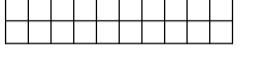
voorgevel
schaal 1 : 100



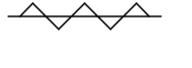

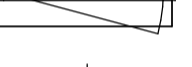

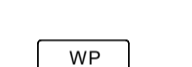
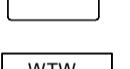
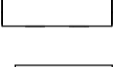

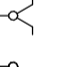
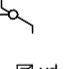
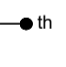
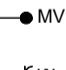
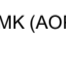
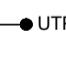

achtergevel
schaal 1 : 100

Renvooi

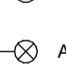
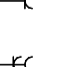
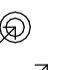
Plattegrond

-  toilet (optioneel gestopt)
-  douche met draingoot
-  wastafel
-  bad
-  wasdrogeraansluiting
-  wasmachinaansluiting
-  vloerverwarming
-  tegelwerk
-  douchescherm
-  schacht
-  verlaagd plafond
-  entree woning
-  brandwerendheid kozijn
-  zelfsluitendheid kozijn (deurdranger)
-  draai-kiepraam
-  deur
-  loopdeur
-  radiator
-  warmtepomp
-  WTW-unit
-  verdeler vloerverwarming

Elektra

-  rookmelder
-  bel
-  dubbele schakelaar
-  enkele schakelaar
-  wisselschakelaar
-  videofoon
-  thermostaat
-  draadloze thermostaat
-  mechanische ventilatie
-  aansluitpunt vloerverwarming
-  overnamepunt meterkast
-  leiding loos
-  leiding bedraad (niet algemeen)
-  centraal aardpunt
-  lichtpunt plafond
-  lichtpunt wand
-  lichtpunt wand met armatuur
- enkele wandcontactdoos
- dubbele wandcontactdoos
- afzuigpunt mechanische ventilatie (indicatief)
- aanvoerpunt mechanische ventilatie (indicatief)



Verkooptekening bnr. 702